

Oneida County Forest Nose Lake Aspen

Tract #22-18
Town of Woodboro

Compartments/Stands: 37/1
Sale Area: 39 Acres (Includes 4 reserve acres)
T36N R7E Sec. 21 E1/2NE, SWNE

Approximate
Sale Location



Contractor: _____
Contract # _____
Date Sold: _____
Date Completed: _____
2 Year Contract

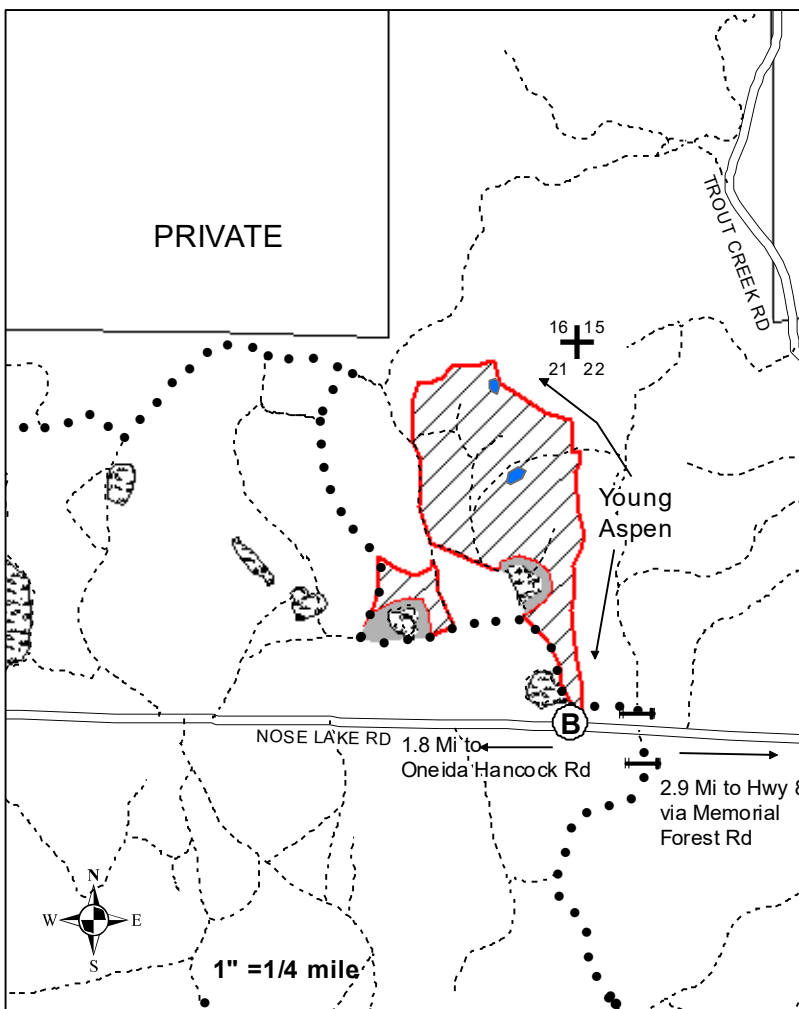

| 4" Top | Est. Vol. | Min. Bid |
|--|-----------------|-----------|
| Aspen | 1505 T (607 cd) | \$14.40/T |
| Mx Hwd* | 325 T (135 cd) | \$12.00/T |
| R Oak | 455 T (165 cd) | \$10.00/T |
| Fir | 25 T (12 cd) | \$9.00/T |
| Mx Hwd = 22% W Birch, 57% R Maple, 21% H Maple | | |
| Whole Tree | Est. Vol. | Min. Bid |
| Aspen | 1990 T (884 cd) | \$10.89/T |
| Mx Hwd* | 480 T (196 cd) | \$8.13/T |
| R Oak | 625 T (227 cd) | \$7.28/T |
| Fir | 25 T (12 cd) | \$9.00/T |
| Mx Hwd = 22% W Birch, 57% R Maple, 21% H Maple | | |

Legend

| | | | |
|--|----------------------|--|----------------|
| | Coppice Harvest Area | | Red Paint Line |
| | Grass Opening | | Section Corner |
| | Town Road | | Woods Roads |
| | Reserve Areas | | Berm/Rocks |
| | Ski Trail | | Gate |
| | Vernal Pond/Wet Area | | |

NOTE: If harvesting occurs during the summer of 2019, all wood must be hauled east on Nose Lk Rd. to Memorial Forest Rd and to Hwy 8. This is due to the Town's plans to re-pave Oneida/Hancock Rd. in the summer of 2019.

- Harvest Requirements.** Dry or frozen conditions will be required for harvesting, skidding or hauling activities. **Harvesting will be permitted from July 15th to December 1st only** and only if rutting and road damage does not occur. Additional restrictions will be imposed if excessive rutting occurs in the woods or on the roads or if excessive damage to the residual trees occurs. Tree length skidding is permitted only if residual damage does not occur. Damage to the residual pine and green marked trees will not be tolerated. Stump Heights may not exceed 10 inches from the ground.
- Harvest Areas:** Do not cut or damage pine, hemlock, spruce, cherry or green marked trees. harvest all other aspen, balsam fir, mixed hardwood and red oak 1" or larger not marked green. This sale must be cut and skidded contiguously and concurrently.
- Utilization is 100" stick to a 4" top or as bid. If harvesting whole tree, 1 in 10 tops above the standard 4" top must be left scattered evenly throughout the sale. Standing dead trees are not to be harvested unless they pose a safety hazard.
- No new roads allowed. Access is via the ski trail. This trail must be returned to its original condition or better at the end of each harvest season (and prior to Dec 1) and at the end of the sale. Landings must have approval of the county prior to construction. The grass openings may be used for landings but must be left completely free of slash and debris and must be graded flat to accommodate mowing in the future. The access from Nose Lk Rd must be bermed, rocked or gated at the end of each harvest season and at the end of the sale. If sale is inactive for longer than 1 week, the access must be blocked to vehicular travel. Bond money will not be returned until all trail/road/dozer work is complete.
- No equipment may be operated within 15 feet of any wetland or vernal pond unless the ground is frozen. No slash is permitted in any wetland within or adjacent to the sale. Equipment may cross Reserve Areas on existing trails to access the grass openings and at one or two additional sites as needed.
- BMP's must be followed on all aspects of the sale.
- All terms of the County Timber Sale Contract also apply.

Sale Est: M. Oradei, Rhn DNR, OCF 9/2018