

Oneida County Forest Lost Blue Hardwood

Compartments / Stands 62/2, 62/12
Harvest Area: 128 acre overstory removal &
21 acre thinning
Legal Desc. T36N R5E Sec. 17 SWSW, Sec. 19
NENE, SENE, NESE Sec. 20 NW1/2, NWSW

Approximate Sale
Location



Tract # 6-18
Town of Little Rice
Contract No.: _____
Contractor: _____
Date Sold: _____
Date Completed: _____
Contract Length: 3 years

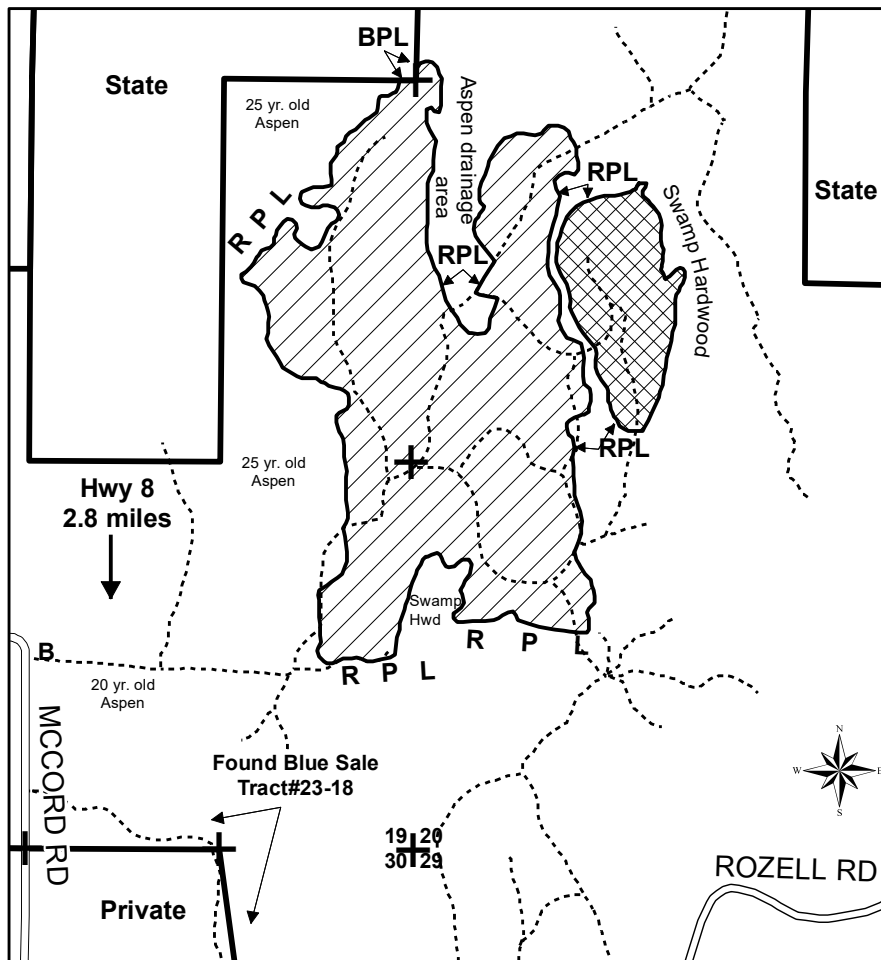

4" Top	Est. Volume	Min. Bid
Mx Hardwood*	4495 Tons (1861 cd)	\$11.00/Ton
Basswood	1255 Tons (650 cd)	\$4.50/Ton
Balsam Fir	160 Tons (75 cd)	\$7.20/Ton
Aspen	35 Tons (16 cd)	\$11.60/Ton

Sawtimber	Est. Volume	Min. Bid
Hard Maple	100 MBF	\$270.00/MBF
Mx Hardwood^	110 MBF	\$153.00/MBF
Basswood	270 MBF	\$141.00/MBF

Mx Hardwood* pulp contains approximately 49% hard huple, 46% red maple, 4% ash and 1% white birch.

Mx Hardwood^ sawtimber contains approximately 80% red maple, 19% ash and 1% white birch.

Legend	
	Thinning Area
	Overstory Removal
	Survey Corner
B	Berm
BPL	Blue Paint Line
RPL	Red Paint Line
	Logging Road
	Town Road

Additional Regulations:

1. In the Overstory Removal Area, cut all NON green-marked maples, basswood, white birch, white ash, black ash and aspen that are 6 inches and larger in this stand. All recent green slashed/ringed trees shall NOT be cut. Trees with old green-faded dots will be harvested. All balsam fir & ironwood 1" and larger is to be cut. All oak, yellow birch, spruce, pine, elm, cedar, hemlock and tamarack will not be cut. In the Thinning Area, cut all orange-marked trees. All balsam fir & ironwood 1" and larger is to be cut. Cut all aspen and black ash that is 6+ inches and larger in this area. The oak, hemlock, spruce, pine, elm, cedar, and tamarack will not be cut. In the gaps, cut all purple-marked trees and all 1" and larger within. Utilization on all species is a 100" stick to a 4" top. Standing dead trees are not to be cut unless they pose a safety hazard. Damage to established regeneration shall be minimized. Run over as much balsam fir as possible to allow for the hardwood regen to take off and grow. Harvesting in these two stands must be CONCURRENT. No patch cutting of areas or certain species is allowed.
2. Operations will be permitted for harvesting and skidding during LEAF-OFF periods ONLY in the OVERSTORY REMOVAL AREA, approximately mid October through spring break-up, and as long as rutting or road damage does not occur. Logging operations in the THINNING AREA may take place from OCTOBER 1 THRU JANUARY 31 ONLY and as long as rutting or road damage does not occur. Time restrictions may be imposed if rutting occurs in the woods or on the roads or if excessive damage to the residual trees occurs.
3. No new roads will be permitted. Existing roads may be opened and improved and landing sites may be constructed with prior approval of the County. The main access road must be blocked off with berms or rocks at the end of each harvest season and at the end of the sale. All trails will be returned to their original condition or better at the end of the sale. Bond money will not be returned until all road/landing rehabilitation is complete.
4. Decking or skidding on any Town Roads will not be allowed unless logger acquires permission. Wood decked near the road must be kept far enough off the road so as not to pose a danger to traffic.
5. No equipment or slash is allowed in the wetland edges/ephemeral ponds, adjacent to the sale or State property. Equipment may not be operated within 15 feet of any wetland unless ground is dry or frozen. Loggers shall stay out of smaller-sized (1"-5") aspen pocket areas and wet drainages areas.
6. It is crucial that a majority of the saplings do not get run over, cut or damaged. If it is determined that too much regeneration is being damaged, all operations must be stopped and these issues shall be discussed with the loggers. If damage to established regeneration is not minimized, the contract may be cancelled and bond money retained.
7. ONLY Fixed-head processors and hand cutters are allowed to harvest this sale. NO Hot-Saws are allowed. ONLY shortwood skidding is allowed. Whole-Tree utilization is not allowed.
8. All items listed in the Oneida County Timber Sale Contract apply. All applicable BMP's will be followed.