

# ONEIDA COUNTY FOREST FIREWOOD AREA

Don Brown Hardwood

Town of Lynne

Compartment/Stand: 81/1  
 Harvest Area: 109 Acres  
 T37N R4E Sec 35: SW1/4, NWSE  
 T36N R4E Sec 1: N1/2NW

Contract No. 1666  
 Contractor: DASSOW  
 Date Sold: 5-4-16  
 Date Completed: \_\_\_\_\_

Contract Length: 2 years

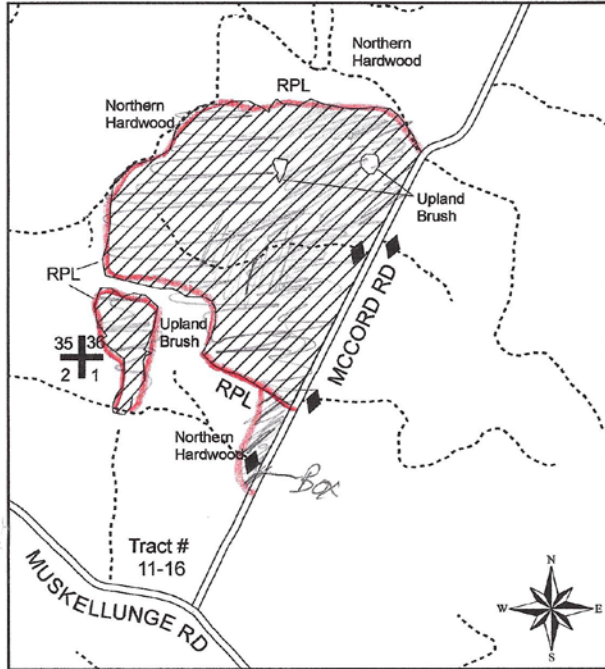

4" Top	Est. Volumes	Minimum Bid
Mixed Hwd*	2790 Tons (1139 cd)	<del>\$41.30/T</del>
Balsam Fir	150 Tons (70 cd)	<del>\$4.70/T</del>
White Spruce	15 Tons (8 cd)	<del>\$14.10/T</del>
Hard Maple Logs	32 MBF	<del>\$185.00/MBF</del>
Mixed Logs**	18 MBF	<del>\$411.00/MBF</del>

\*Mixed Hwd: 60% H. Maple, 37% R. Maple, 3% W. Birch/Mixed  
 \*\*Mixed Logs: 84% R. Maple, 8% Ash, 8% Oak

Legend	
	Marked Hardwood Area
RPL	Red Paint Line
	Town Rd
	Logging Rd
	Survey Corner
	Berm

## Firewood Harvest Regulations:

Do not cut standing trees, dead or not.

Harvest firewood only from tops and branches of logging debris.

All roads and trails are to be kept free from branches and debris.

If you have any questions, contact Oneida County Forestry Dept at 715-369-6140