

ONEIDA COUNTY FOREST FIREWOOD AREA

Green Machine

Harvest Area: 175 acres
 Legal Desc; T35N R9E Sec. 10: N1/2, N1/2SE,
 NESW. Sec. 11: SWNW

Green Machine

Town of Enterprise

Contract No. 1627

Contractor DVORAK

Date Sold: 11-5-14

Date Completed: _____

Contract Length: 2 Years

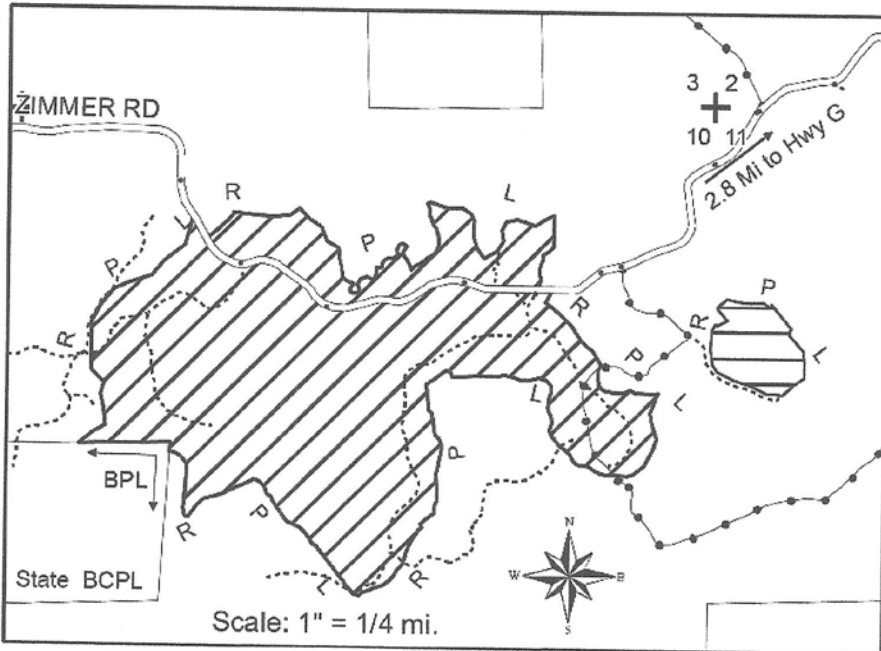

Estimated Vol	Min Bid
*Mx Hwd 2150 T (878 Cd)	\$1120/T
Basswood 135 T (70 Cd)	\$260/T
Balsam Fir 160 T (75 Cd)	\$470/T
Hemlock 60 T (25 Cd)	\$290/T

Logs		
H Maple	32 MBF	\$259.00/MBF
Basswood	29 MBF	\$129.00/MBF
** Mx Hwd	116 MBF	\$150.00/MBF

*Mx Pulp: 50% H Maple, 30% S Maple,
 8% W Ash, 6% W Birch, 2% R Oak
 2% Aspen, 2% Misc.

** Mx Logs: 62% R Maple, 33% Ash,
 3% W Birch

Legend			
Harvest Area 1	Vernal Pond	RPL Red Paint Line	Ski Trail
Harvest Area 2	Co Forest Rd	BPL Blue Paint Line	Survey Corners
	Logging Road		

Firewood Harvest Regulations:

Do not cut standing trees, dead or not.

Harvest firewood only from tops and branches of logging debris.

All roads and trails are to be kept free from branches and debris.

If you have any questions, contact Oneida County Forestry Dept at
 715-369-6140