

ONEIDA COUNTY FOREST FIREWOOD AREA

Town of Lynne





Turcott Bear-ly Beginning

CMPT / STAND: 99 / 1,2
 CUTTING AREA: 80 ACRES
 DESCRIPTION: T37N R4E, SEC. 7
 N1/2NW, W1/2NE,
 NWSE
 CONTRACT LENGTH: 2 YEARS

TRACT # 01-13
 CONTRACT # _____
 TOWNSHIP OF: Lynne (N)
 CONTRACTOR: _____
 DATE SOLD: _____
 DATE COMPLETED: _____

EST. VOLUMES		MIN BID	
*Mixed Hardwood	1305	Tons	\$11.20/ ton
Basswood	145	Tons	\$2.60/ton
Aspen	300	Tons	\$11.11/ ton
Balsam Fir	65	Tons	\$4.70 / ton
(*~68% Hard maple, 25% Red maple, 7% misc.)			
BASSWOOD LOGS	12	MBF	\$150.00 / MBF
**MX HRD LOGS	15	MBF	\$150.00 / MBF
(**~82% Hard maple, 10% Red maple and 8% Ash)			

Legend

- Red Paint Line: RPL
- Blue Paint Line: BPL
- Gate: 
- Town Road: 
- Woods Road: 
- Section Corner: +
- Area #1: 
- Area #2: 

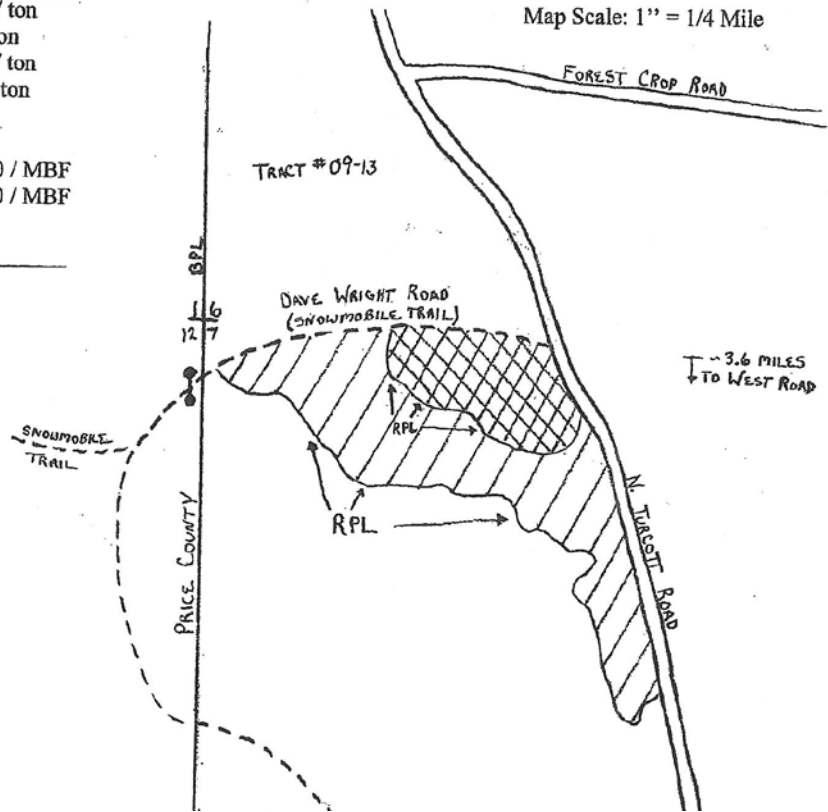

Firewood Harvest Regulations:

Do not cut standing trees, dead or not.

Harvest firewood only from tops and branches of logging debris.

All roads and trails are to be kept free from branches and debris.

If you have any questions, contact Oneida County Forestry Dept at 715-369-6140