

ONEIDA COUNTY FOREST FIREWOOD AREA

Compartment/Stand 10/11
 Harvest Area 87 Acres
 Legal Desc. T35N R9E Sec. 34 SW1/4,
 SWNW Sec. 33 NESE

Oneida County Forest Whale Tail Sale

Tract #1-15
 Town of Enterprise *1648*
 Contract No.: _____
 Contractor: *F-wood*
 Date Sold: *11-4-17*
 Date Completed: _____
 Contract Length: 2 years

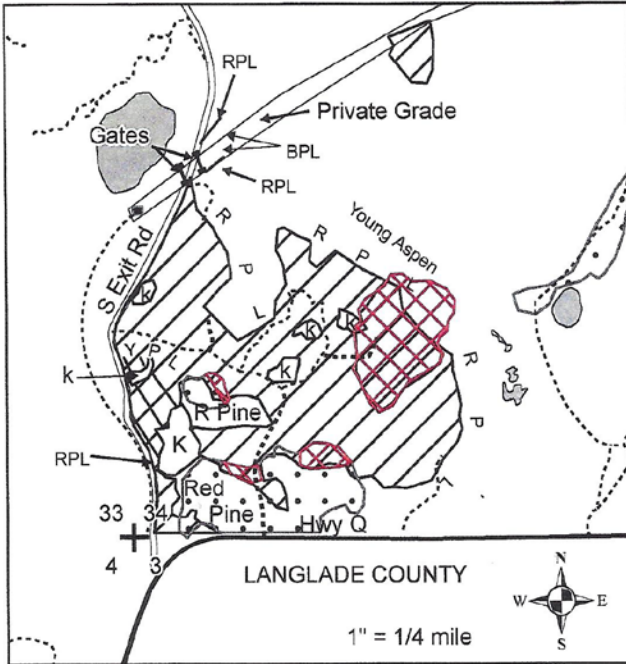

| Legend | |
|--------|---------------------|
| | Marked Hardwood |
| | Shelterwood Area |
| | County Forest Roads |
| | Woods Roads |
| | Survey Corners |
| | RPL Red Paint Line |
| | BPL Blue Paint Line |
| | YPL Red Paint Line |
| | K Keg/Wetland |

| 4" Top | Est. Volume | Min. Bid |
|------------|--------------------|------------------------|
| Mx Hwd* | 1065 Tons (435 cd) | \$13.00/Ton |
| Basswood | 400 Tons (189 cd) | \$3.20/Ton |
| R Oak | 33 Tons (12 cd) | \$6.50/Ton |
| Balsam Fir | 50 Tons (24 cd) | \$4.80/Ton |
| Basswood | 43 MBF | \$129.00/MBF |
| H Maple | 9 MBF | \$258.00/MBF |
| Mx Hwd** | 6 MBF | \$155.00/MBF |
| R Oak | 4 MBF | \$258.00/MBF |

| Whole Tree | | |
|------------|--------------------|-----------------------|
| Mx Hwd* | 1585 Tons (647 cd) | \$8.74/Ton |
| Basswood | 490 Tons (254 cd) | \$2.61/Ton |
| R Oak | 35 Tons (13 cd) | \$6.13/Ton |
| Balsam Fir | 120 Tons (57 cd) | \$2.00/Ton |
| Basswood | 43 MBF | \$129.00/MBF |
| H Maple | 9 MBF | \$258.00/MBF |
| Mx Hwd** | 6 MBF | \$155.00/MBF |
| R Oak | 4 MBF | \$258.00/MBF |

* MX pulp includes 67% H. maple, 30% red maple and 3% miscellaneous.
 **MX sawlogs includes 50% R Maple, 33% W Ash, 17% Misc

Firewood Harvest Regulations:

Do not cut standing trees, dead or not.

Harvest firewood only from tops and branches of logging debris.

All roads and trails are to be kept free from branches and debris.

If you have any questions, contact Oneida County Forestry Dept at 715-369-6140